

58 PM 19

OWNER'S STATEMENT:

WE, THE UNDERSIGNED, HEREBY STATE THAT WE ARE THE OWNERS OF, OR HAVE SOME RIGHT, TITLE OR INTEREST OF RECORD IN THE LANDS SHOWN ON THIS MAP, AND WE CONSENT TO THE MAKING AND FILING OF THIS MAP IN THE OFFICE OF THE COUNTY RECORDER OF STANISLAUS COUNTY, CALIFORNIA.

WE OFFER FOR DEDICATION TO THE CITY OF TURLOCK, A MUNICIPAL CORPORATION, THE REAL PROPERTY AS DESCRIBED BELOW AS EASEMENTS FOR PUBLIC PURPOSES:

THE PUBLIC UTILITY EASEMENT LYING ADJACENT TO AND ABUTTING CHRISTOFFERSEN PARKWAY RIGHT-OF-WAY AND CROWELL AVENUE RIGHT-OF-WAY, BOTH AS ILLUSTRATED ON THIS MAP.

WE ALSO OFFER FOR DEDICATION TO THE TURLOCK IRRIGATION DISTRICT, A GOVERNMENTAL AGENCY, THE REAL PROPERTY AS AN EASEMENT FOR AN UNDERGROUND ELECTRICAL LINE AND NECESSARY APPURTENANCES, LYING WITHIN THE EXTERIOR BOUNDARY OF THE LANDS BEING DIVIDED AND AS ILLUSTRATED ON THIS MAP.

DATED THIS 23 DAY OF July 2020.

OWNER(S):
CORNERSTONE COVENANT CHURCH, A CALIFORNIA NOT FOR PROFIT CORPORATION

BY: Justin Marty JUSTIN MARTY, CHAIRMAN
BY: Marlene Stante MARLENE STANTE, VICE CHAIR

NOTARY'S ACKNOWLEDGMENT:

A NOTARY PUBLIC OR OTHER OFFICER COMPLETING THIS CERTIFICATE VERIFIES ONLY THE IDENTITY OF THE INDIVIDUAL WHO SIGNED THE DOCUMENT TO WHICH THIS CERTIFICATE IS ATTACHED, AND NOT THE TRUTHFULNESS, ACCURACY, OR VALIDITY OF THAT DOCUMENT.

STATE OF CALIFORNIA:

COUNTY OF Stanislaus

ON July 23, 2020 BEFORE ME, Nina L. Ratliff, A NOTARY PUBLIC PERSONALLY APPEARED,

Justin Marty and Marlene Stante

WHO PROVED TO ME ON THE BASIS OF SATISFACTORY EVIDENCE TO BE THE PERSON(S) WHOSE NAME(S) IS/ARE SUBSCRIBED TO THE WITHIN INSTRUMENT AND ACKNOWLEDGED TO ME THAT HE/SHE/THEY EXECUTED THE SAME IN HIS/HER/THEIR AUTHORIZED CAPACITY(IES), AND THAT BY HIS/HER/THEIR SIGNATURE(S) ON THE INSTRUMENT THE PERSON(S), OR THE ENTITY UPON BEHALF OF WHICH THE PERSON(S) ACTED, EXECUTED THE INSTRUMENT.

I CERTIFY UNDER PENALTY OF PERJURY UNDER THE LAWS OF THE STATE OF CALIFORNIA THAT THE FOREGOING PARAGRAPH IS TRUE AND CORRECT.

WITNESS MY HAND.

Nina L. Ratliff, NOTARY PUBLIC

PRINT NAME: Nina L. Ratliff

COMMISSION NUMBER: 2206917

COMMISSION EXPIRES: August 20, 2021

PRINCIPAL OFFICE LOCATION (COUNTY): Stanislaus



OMITTED SIGNATURES:

PURSUANT TO SECTION 66436 OF THE SUBDIVISION MAP ACT, THE SIGNATURES OF THE FOLLOWING EASEMENT HOLDERS OF RECORD HAVE BEEN OMITTED:

PACIFIC BELL TELEPHONE COMPANY, A CALIFORNIA CORPORATION (DBA SBC CALIFORNIA) FACILITIES EASEMENT, BY DOCUMENT RECORDED MAR. 7, 2006 AS DOCUMENT NUMBER 2006-034475 OF OFFICIAL RECORDS, S.C.R.

LANDSCAPING AND LIGHTING ASSESSMENT DISTRICT AND THE STREET MAINTENANCE BENEFIT ASSESSMENT AREA STATEMENT:

ALL PARCELS IN THIS SUBDIVISION ARE SUBJECT TO A LANDSCAPING AND LIGHTING ASSESSMENT DISTRICT AND THE STREET MAINTENANCE BENEFIT ASSESSMENT AREA, CONFIRMED BY RESOLUTION NO. 2020-02 OF THE CITY COUNCIL OF THE CITY OF TURLOCK AT ITS REGULARLY SCHEDULED MEETING ON July 9, 2020. THE BOUNDARIES OF THE BENEFIT ASSESSMENT AREA ARE COINCIDENT WITH THE SUBDIVISION BOUNDARY DEPICTED HEREON.

CLERK OF THE BOARD OF SUPERVISOR'S CERTIFICATE:

THIS IS TO CERTIFY THAT THE OWNERS OF THE PROPERTY SHOWN ON THE ACCOMPANYING MAP HAVE FILED WITH THE BOARD OF SUPERVISORS: (CHECK ONE)

- ☒ A. A BOND OR DEPOSIT APPROVED BY SAID BOARD TO SECURE THE PAYMENT OF TAXES AND SPECIAL ASSESSMENTS COLLECTED AS TAXES, WHICH ARE AT THE TIME OF FILING THIS MAP, A LIEN AGAINST SAID PROPERTY OR ANY PART THEREOF.
- ☐ B. RECEIPTED TAX BILL OR BILLS OR SUCH OTHER EVIDENCE AS MAY BE REQUIRED BY SAID BOARD SHOWING FULL PAYMENT OF ALL APPLICABLE TAXES.

DATED THIS 24th DAY OF August 2020.

ELIZABETH A. KING
CLERK OF THE BOARD OF SUPERVISORS.

BY: Kelly Rodriguez DEPUTY
Kelly Rodriguez
PRINT NAME

TAX COLLECTOR'S STATEMENT:

THIS IS TO CERTIFY THAT THERE ARE NO LIENS FOR ANY UNPAID STATE, COUNTY, SCHOOLS, MUNICIPAL, OR SPECIAL ASSESSMENTS, EXCEPT SPECIAL ASSESSMENTS OR TAXES NOT YET PAYABLE AGAINST THE LAND SHOWN ON THIS MAP.

ASSESSOR'S PARCEL NO. 071-001-011-000
DATED THIS 24th DAY OF August 2020.

DONNA RILEY
COUNTY TAX COLLECTOR.

BY: Angie Alcala DEPUTY
Angie Alcala
PRINT NAME

TURLOCK IRRIGATION DISTRICT
CERTIFICATE OF ACCEPTANCE:

THIS IS TO CERTIFY THAT THE INTERESTS IN REAL PROPERTY CONVEYED BY THIS PARCEL MAP TO THE TURLOCK IRRIGATION DISTRICT, A GOVERNMENTAL AGENCY, IS HEREBY ACCEPTED BY THE UNDERSIGNED AUTHORIZED REPRESENTATIVE ON BEHALF OF THE TURLOCK IRRIGATION DISTRICT PURSUANT TO TURLOCK IRRIGATION DISTRICT RULE NUMBER (RL) 0340.001 AND THE DISTRICT CONSENTS TO THE RECORDATION THEREOF BY ITS DULY AUTHORIZED REPRESENTATIVE.

DATED THIS 14 DAY OF August 2020.

BY: Manjot S. Gill
MANJOT S. GILL
ASSISTANT GENERAL MANAGER
ELECTRICAL ENGINEERING AND OPERATIONS

CERTIFICATE / ACCEPTANCE OF DEDICATION

THIS IS TO CERTIFY THAT THE INTEREST IN THE REAL PROPERTY CONVEYED BY THIS MAP FROM THE OWNERS STATED ABOVE TO THE CITY OF TURLOCK, A MUNICIPAL CORPORATION, IS HEREBY ACCEPTED BY THE UNDERSIGNED OFFICER ON BEHALF OF THE CITY OF TURLOCK, PURSUANT TO AUTHORITY CONFERRED BY RESOLUTION NO. 2012-025 OF THE CITY COUNCIL OF THE CITY OF TURLOCK ON FEBRUARY 28, 2012 AND THE GRANTEE CONSENTS TO THE RECORDATION THEREOF BY ITS DULY AUTHORIZED OFFICER.

THE CITY OF TURLOCK ACCEPTS THE OFFER OF DEDICATION TO THE PUBLIC FOR PUBLIC PURPOSES THE PUBLIC UTILITY EASEMENT LYING ADJACENT TO AND ABUTTING CHRISTOFFERSEN PARKWAY RIGHT-OF-WAY AND CROWELL AVENUE RIGHT-OF-WAY, AND ANY OTHER PUBLIC PLACES AND DEDICATIONS SHOWN ON THIS MAP WITHIN THE EXTERIOR BOUNDARIES OF THE LAND BEING DIVIDED.

DATED THIS 27th DAY OF August 2020.

Jennifer Land
JENNIFER LAND
CITY CLERK, CITY OF TURLOCK

IMPROVEMENT CERTIFICATE:

AS A CONDITION OF APPROVAL OF THIS PARCEL MAP, THE CITY ENGINEER HAS REQUIRED THAT FRONTAGE IMPROVEMENTS BE INSTALLED FOR ALL PARCELS PRIOR TO THE OCCUPANCY OF ANY DEVELOPMENT ON EACH CORRESPONDING PARCEL. IMPROVEMENT REQUIREMENTS ARE MORE SPECIFICALLY CONTAINED IN CONDITIONS OF APPROVAL FOR PARCEL MAP NO. 20-02 ADOPTED ON JULY 9, 2020 OR ANY SUBSEQUENT AMENDMENT THERETO.

SURVEYOR'S STATEMENT:

THIS MAP WAS PREPARED BY ME OR UNDER MY DIRECTION AND IS BASED UPON A FIELD SURVEY IN CONFORMANCE WITH THE REQUIREMENTS OF THE SUBDIVISION MAP ACT AND LOCAL ORDINANCE AT THE REQUEST OF LINDA STUHMER, EMC HEALTH IN JULY, 2020. I HEREBY STATE THAT THIS MAP SUBSTANTIALLY CONFORMS TO THE CONDITIONALLY APPROVED TENTATIVE MAP, AND THAT THE MONUMENTS ARE OF THE CHARACTER AND OCCUPY THE POSITIONS INDICATED. THE MONUMENTS ARE SUFFICIENT TO ENABLE THE SURVEY TO BE RETRACED.

DATED THIS 18th DAY OF August 2020.

Dave Skidmore
DAVE SKIDMORE, P.L.S. 7126

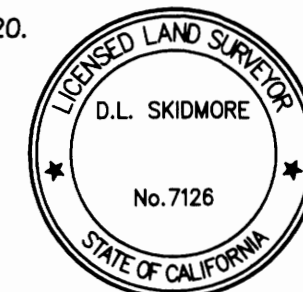

CITY LAND SURVEYOR'S STATEMENT:

I HEREBY STATE THAT I HAVE EXAMINED THE ACCOMPANYING PARCEL MAP AND THAT THE MAP IS TECHNICALLY CORRECT.

DATED THIS 24th DAY OF August 2020.

Scott Thomas Delamare
SCOTT THOMAS DELAMARE, P.L.S. NO. 8078
ACTING CITY LAND SURVEYOR

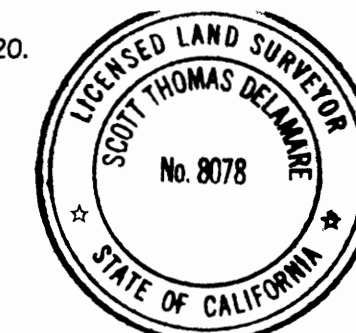

CITY ENGINEER'S STATEMENT:

I HEREBY STATE THAT I HAVE EXAMINED THE ACCOMPANYING PARCEL MAP; THAT THE SUBDIVISION AS SHOWN IS SUBSTANTIALLY THE SAME AS IT APPEARED ON THE VESTING TENTATIVE MAP, AND ANY APPROVED ALTERATIONS THEREOF; THAT ALL PROVISIONS OF THE SUBDIVISION MAP ACT AND OF THE MUNICIPAL CODE, AND ANY AMENDMENTS THERETO, APPLICABLE AT THE TIME OF APPROVAL OF THE VESTING TENTATIVE MAP HAVE BEEN COMPLIED WITH.

DATED THIS 25th DAY OF August 2020.

Nathan B. Bray
NATHAN B. BRAY, CITY ENGINEER
REGISTRATION NO. 76642



COUNTY RECORDER'S STATEMENT:

FILED THIS 1st DAY OF September, 2020 AT 11:24:04 A.M.

IN BOOK 58 OF PARCEL MAPS, AT PAGE 19, STANISLAUS COUNTY RECORDS
AT THE REQUEST OF ASSOCIATED ENGINEERING GROUP, INC.

INSTRUMENT NO. 2020-0065935-00

FEE: \$ 0 PAID

DONNA LINDER
STANISLAUS COUNTY CLERK RECORDER

BY: Julie Cano
ASSISTANT / DEPUTY RECORDER

PARCEL MAP

NO. 20-02

BEING A DIVISION OF PARCEL 1 AS SHOWN ON THAT MAP FILED IN BOOK 48 OF PARCEL MAPS AT PAGE 50, S.C.R., LYING WITHIN THE EAST HALF OF THE SOUTHWEST QUARTER OF THE NORTHWEST QUARTER OF SECTION 3, T. 5 S., R. 10 E. M.D.M CITY OF TURLOCK, COUNTY OF STANISLAUS, STATE OF CALIFORNIA

PREPARED FOR: JESSICA'S HOUSE
JULY, 2020



4206 TECHNOLOGY DRIVE, SUITE 4, MODESTO, CA 95356
PHONE: (209) 545-3390 FAX: (209) 545-3875 www.assoceng.com

58 PM 19

58 PM 19

