

OWNER'S STATEMENT

WE HEREBY STATE THAT WE ARE THE OWNERS OF OR HAVE SOME RIGHT, TITLE OR INTEREST IN AND TO THE REAL PROPERTY INCLUDED WITHIN THE SUBDIVISION SHOWN UPON THE HEREIN MAP; THAT WE ARE THE ONLY PERSONS WHOSE CONSENT IS NECESSARY TO PASS A CLEAR TITLE TO SAID REAL PROPERTY AS SET FORTH UNDER GOVERNMENT CODE, SECTION 66436 (c); THAT WE CONSENT TO THE PREPARATION AND RECORDATION OF SAID MAP AND SUBDIVISION AS SHOWN WITHIN THE DISTINCTIVE BORDER LINE.

WE HEREBY DEDICATE TO PUBLIC USE AND OFFER TO DEDICATE TO THE CITY OF GILROY THOSE STREETS AND PORTIONS OF STREETS NOT HERETOFORE EXISTING AS SHOWN UPON THIS MAP: SAID DEDICATIONS AND OFFERS OF DEDICATION ARE FOR ANY AND ALL PUBLIC USES UNDER, OVER, ON AND ACROSS SAID STREETS AND PORTIONS THEREOF.

WE HEREBY DEDICATE TO PUBLIC USE AND OFFER TO DEDICATE TO THE CITY OF GILROY EASEMENTS FOR ANY AND ALL PUBLIC SERVICE PURPOSES INCLUDING BUT NOT LIMITED TO SIDEWALKS, POLES, WIRES AND CONDUITS FOR ELECTRICAL, TELEPHONE, TELEVISION, TRAFFIC SIGNALS, GAS, STORM DRAIN, SANITARY SEWER AND WATER SERVICES AND ALL APPURTENANCES THERETO UNDER, OVER, ON AND ACROSS THOSE STRIPS OF LAND DESIGNATED AS P.U.E. (PUBLIC USE EASEMENT) AS SHOWN ON THE WITHIN MAP.

WE HEREBY OFFER TO DEDICATE TO THE CITY OF GILROY EASEMENTS FOR TREE PLANTING UNDER, OVER, ON AND ACROSS THAT STRIP OF LAND DESIGNATED T.P.E. (TREE PLANTING EASEMENT) AS SHOWN ON THE WITHIN MAP.

ALL OF THE HEREIN DESCRIBED STREETS AND EASEMENTS SHALL BE KEPT FREE OF ALL BUILDINGS, EXCEPT LAWFUL UNSUPPORTED ROOF OVERHANGS AND OBSTRUCTIONS THAT IMPAIR THE USE OR ARE INCONSISTENT WITH THE PURPOSES OF THE STREET AND EASEMENT.

SUBDIVIDER SHALL DEFEND, INDEMNIFY AND HOLD HARMLESS THE CITY, ITS CITY COUNCIL, PLANNING COMMISSION, AGENTS, OFFICERS AND EMPLOYEES FROM ANY CLAIM, ACTION OR PROCEEDING AGAINST THE CITY OR ITS CITY COUNCIL, PLANNING COMMISSION, AGENTS, OFFICERS OR EMPLOYEES TO ATTACK, SET ASIDE, VOID OR ANNULL AN APPROVAL OF THE CITY, CITY COUNCIL, PLANNING COMMISSION, OR OTHER BOARD, ADVISORY AGENCY OR LEGISLATIVE BODY CONCERNING THIS SUBDIVISION. CITY WILL PROMPTLY NOTIFY THE SUBDIVIDER OF ANY CLAIM, ACTION OR PROCEEDING AGAINST IT AND WILL COOPERATE FULLY IN THE DEFENSE. THIS CONDITION IS IMPOSED PURSUANT TO CALIFORNIA GOVERNMENT CODE SECTION 66474.9.

OWNER: THE ESTATE OF NELLIE OLIVE ISABELL BEACH

By: *Deana Narvaez*  
JOYCE DEANA NARVAEZ - ADMINISTRATOR

STATE OF CALIFORNIA }  
COUNTY OF SANTA CLARA } SS

ON Oct 24, 1996 BEFORE ME Marjorie Fuller  
PERSONALLY APPEARED Joyce Deana Narvaez

PERSONALLY KNOWN TO ME (OR PROVED TO ME ON THE BASIS OF SATISFACTORY EVIDENCE) TO BE THE PERSON(S) WHOSE NAME(S) IS/ARE SUBSCRIBED TO THE WITHIN INSTRUMENT AND ACKNOWLEDGED TO ME THAT HE/SHE/THEY EXECUTED THE SAME IN HIS/HER/THEIR AUTHORIZED CAPACITY(IES), AND THAT BY HIS/HER/THEIR SIGNATURE(S) ON THE INSTRUMENT THE PERSON(S), OR THE ENTITY UPON BEHALF OF WHICH THE PERSON(S) ACTED, EXECUTED THE INSTRUMENT.

WITNESS MY HAND  
NOTARY'S SIGNATURE *Marjorie Fuller*

EXPIRATION OF NOTARY'S COMMISSION Sept 7 .1999

NOTARY'S PRINCIPAL PLACE OF BUSINESS(COUNTY) Santa Clara

Tract No. 8890  
MISSION VALLEY

Portion of Lot 36, Henry Miller's subdivision  
of Las Animas Ranch Lot 23  
shown on Book "H" of Maps, Page 5  
in the City of Gilroy  
Santa Clara County, California  
August, 1996 Scale: as noted

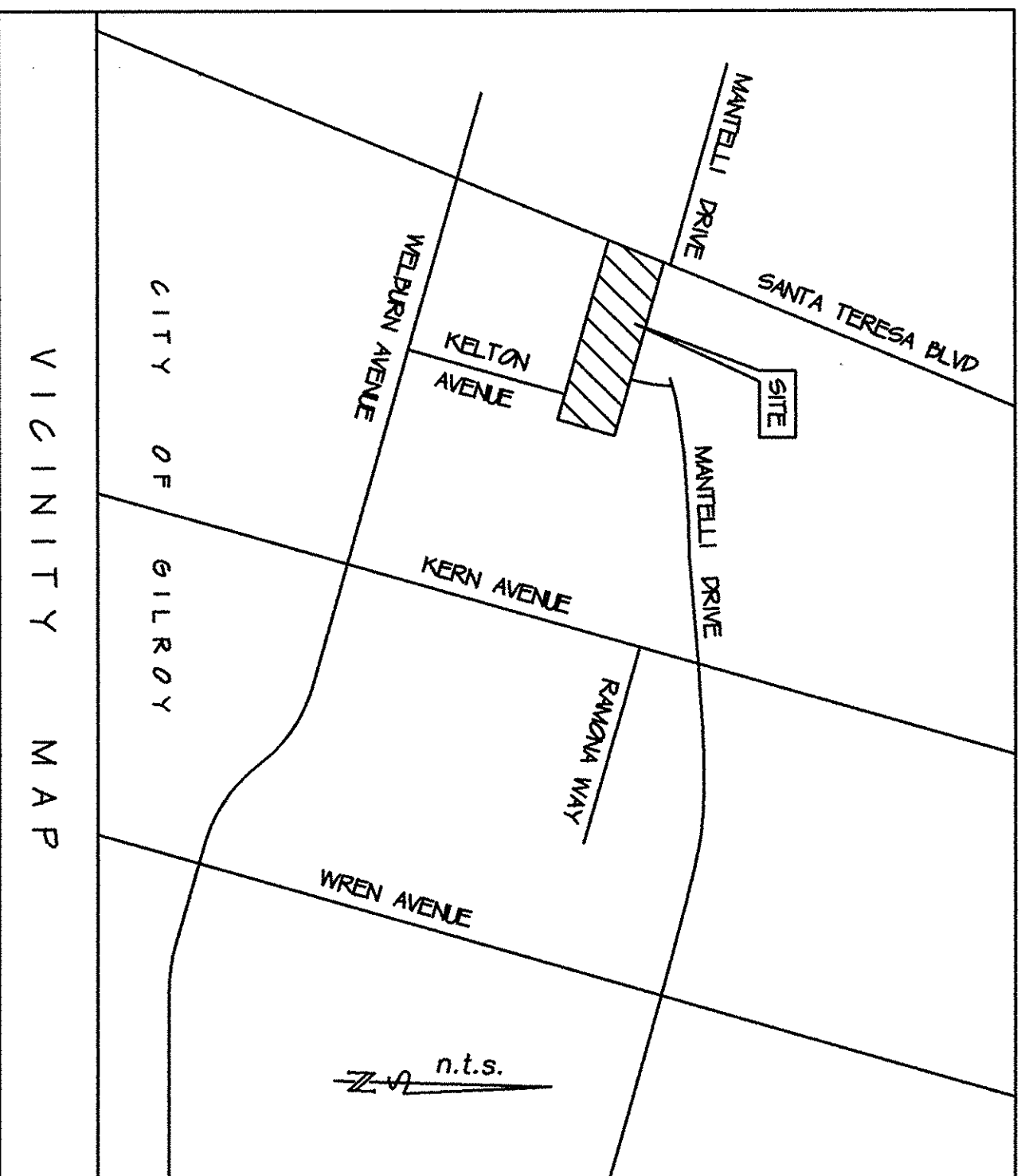

ENGINEER'S STATEMENT

I HEREBY STATE THAT THIS FINAL MAP AND THE SURVEY WERE MADE BY ME OR UNDER MY DIRECTION; THAT THE SURVEY WAS MADE DURING JULY, 1996, IS TRUE AND COMPLETE AS SHOWN; THAT ALL THE MONUMENTS ARE OF THE CHARACTER AND OCCUPY THE POSITIONS INDICATED, OR WILL BE SET IN SUCH POSITIONS ON OR BEFORE Oct. 1997 AND THAT SUCH MONUMENTS ARE SUFFICIENT TO ENABLE THE SURVEY TO BE RETRACED.

SIGNED AND SEALED  
*Arnold R. Brunetti*  
ARNOLD R. BRUNETTI  
R.C.E. 17186, EXP. 6/30/97

CITY ENGINEER'S STATEMENT

I HEREBY STATE THAT I HAVE EXAMINED THE FINAL MAP OF TRACT NO. 8890, "MISSION VALLEY", THE SUBDIVISION AS SHOWN THEREON IS SUBSTANTIALLY THE SAME AS IT APPEARED ON THE APPROVED TENTATIVE MAP THEREOF AND ANY APPROVED ALTERATIONS; THAT ALL THE PROVISIONS OF THE SUBDIVISION MAP ACT AND ANY LOCAL ORDINANCE APPLICABLE AT THE TIME OF THE APPROVAL OF THE TENTATIVE MAP HAVE BEEN COMPLIED WITH AND THAT I AM SATISFIED THAT SAID MAP IS TECHNICALLY CORRECT.

DATED: Oct. 28 1996  
*Norman S. Allen*  
NORMAN S. ALLEN  
R.C.E. NO. 26092  
EXPIRES: 5-31-98

STATEMENT OF THE PLANNING COMMISSION

I HEREBY STATE THAT THE MAP OF TRACT NO. 8890, "MISSION VALLEY", SUBDIVISION WAS DULY APPROVED BY THE PLANNING COMMISSION OF THE CITY OF GILROY ON 7/11/96

*Norman S. Allen*  
NORMAN S. ALLEN  
SECRETARY

STATEMENT OF THE CITY CLERK

THE MAP OF TRACT NO. 8890, "MISSION VALLEY", SUBDIVISION HAVING BEEN PRESENTED TO THE CITY COUNCIL OF THE CITY OF GILROY, CALIFORNIA, ON THE DAY OF October 1996 IT IS HEREBY APPROVED. IT IS ORDERED THAT ALL STREETS AND EASEMENTS AS SHOWN UPON SAID MAP BE ACCEPTED ON BEHALF OF THE PUBLIC FOR THE USE INTENDED.

*Rhonda Pellin*  
RHONDA PELLIN  
DEPUTY CITY CLERK, CITY OF GILROY

RECORDER'S STATEMENT

FILED THIS 30th DAY OF October 1996 AT 12:34 PM, IN BOOK 683 OF MAPS AT PAGE 44 AT THE REQUEST OF HANNA & BRUNETTI.

FILE NO. 13502201 BRENDA DAVIS  
COUNTY RECORDER, COUNTY OF SANTA CLARA  
STATE OF CALIFORNIA

FEE: \$10.00 BY: *Robert L. Brunetti* *REC'D*  
DEPUTY

HANNA & BRUNETTI  
CIVIL ENGINEERS & SURVEYORS - GILROY, CALIF.  
SHEET 1 OF 2 JOB NO. 96004