

CORNER RECORD

Document Number

CR 2572

City of Unincorporated Eden Twp.

County of

Alameda

California

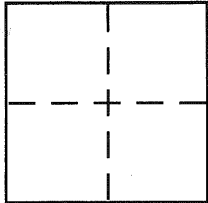
Brief Legal Description LOT 68, BLOCK B, TRACT 3814, filed 5/11/78, 100M. 70-85

CORNER TYPE

Government Corner ☐ Control ☐
Meander ☐ Property ☒
Rancho ☐ Other ☐
Date of Survey Apr. 14, 2004

COORDINATES (Optional)

N. _____
E. _____
Zone _____ NAD27 ☐ NAD83 ☐
NAD83 Epoch _____
Elev. _____
Vert. Datum: NGVD29 ☐ NAVD88 ☐
Meas. Units: Metric ☐ Imperial ☒

Corner -

Left as found ☐Found and tagged ☐Established ☒Reestablished ☐Rebuilt ☐

Identification and type of corner found: Evidence used to identify or procedure used to establish or reestablish the corner:

Held record relationship of line surveyed with the std.
Alameda County conc. monuments shown found in
West Cavendish Drive as per map of Tract 3814.
(See Page 2)

A description of the physical condition of the monument as found and as set or reset:

See Legend
(Page 2)

SURVEYOR'S STATEMENT

This Corner Record was prepared by me or under my direction in conformance with
the Land Surveyor's Act on April 27, 2004.

Signed

P.L.S. or R.C.E. No.

5666

COUNTY SURVEYOR'S STATEMENT

This Corner Record was received

10/24/2005

and examined and filed

12-9-05

Signed

P.L.S. or R.C.E. No.

5726

Title

COUNTY SURVEYOR

County Surveyor's Comment

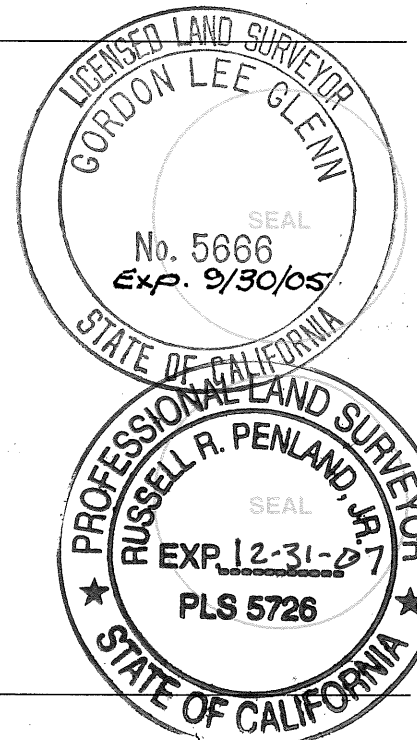

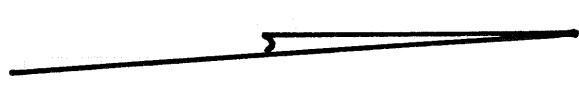

SCALE: 1" = 30'

BLOCK B

05/11/78

95 EASEMENT
P.G. & E.
N 30° 27' 33" W
28.38

TRACT 3814

100 M, 70-85

67

63

69

N 73° 42' 28" W (Radial)

N 81° 51' 24" E (Radial)

$\Delta = 24^\circ 26' 08"$

$L = 91.69$

$R = 215.00'$

167.99

30.86

128.00

PUE

5'

23.91

N 3° 59' 12" E

143.57 rec. & meas.

WEST

CAVENDISH

DRIVE

LEGEND:

Exterior Boundary

Found std. Alameda County conc. monument

set nail w/ brass tag L.S. 5666 on conc. sidewalk

set nail w/ plastic tag L.S. 5666 on E'ly side of fence post

G. Glenn