

FAN #3 DR12HFA - EXHAUST FAN

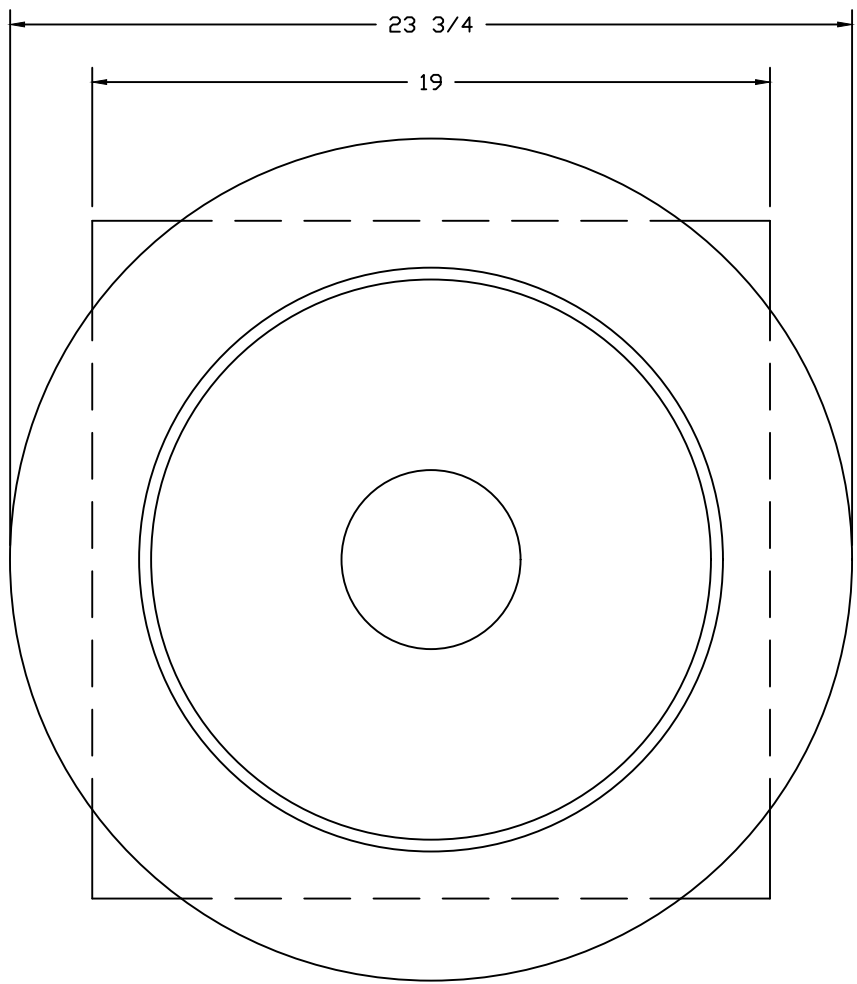

TOP VIEW

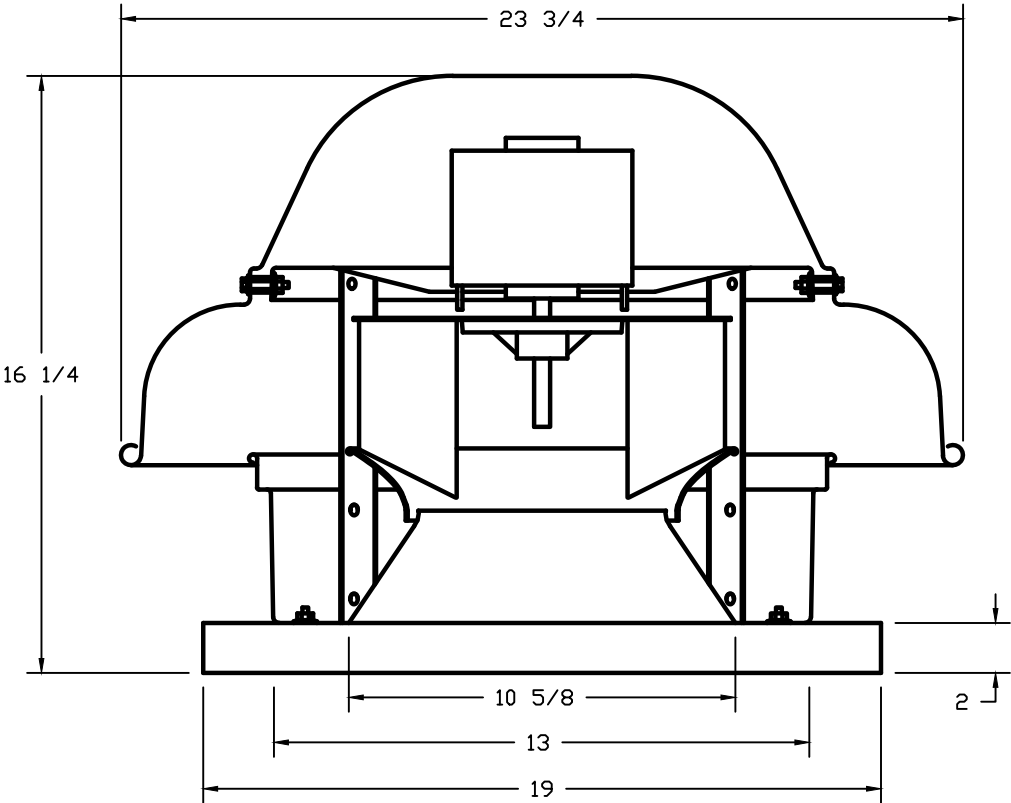

FEATURES:

- DIRECT DRIVE CONSTRUCTION (NO BELTS/PULLEYS).
- ROOF MOUNTED FANS.
- UL705.
- SAFETY DISCONNECT.
- STANDARD BIRD SCREEN.
- SPEED CONTROL.

OPTIONS

ECM WIRING PACKAGE - MANUAL OR 0-10VDC REFERENCE SPEED CONTROL (VELCO MOTOR), CCW ROTATION.
1 1/2-BDD DAMPER.
MIAMI DADE CERTIFICATION - NDA-1 ALUMINUM DOWNBLAST 10,
2 YEAR PARTS WARRANTY.

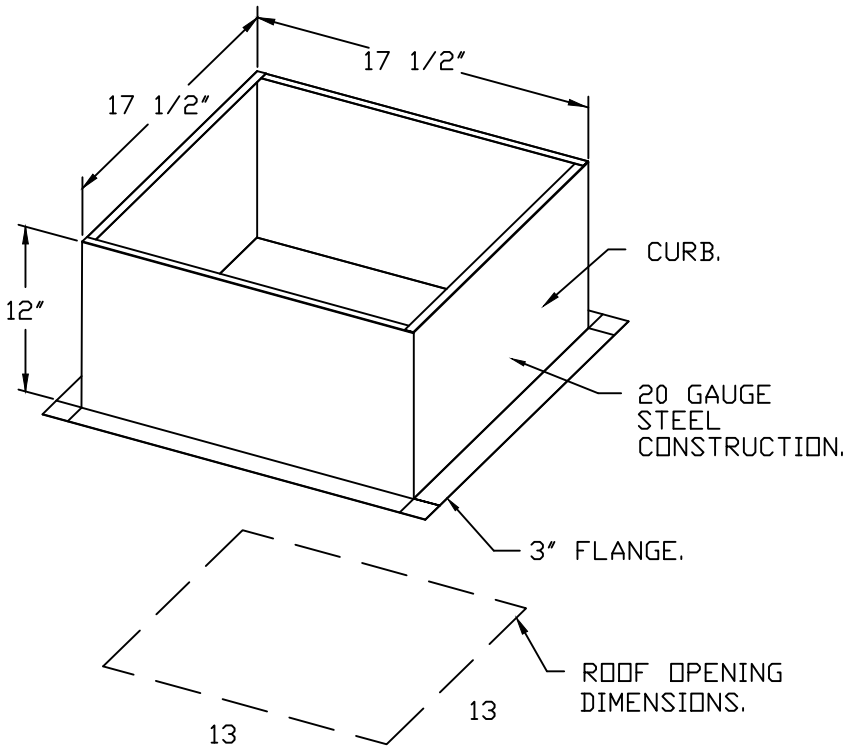

PITCHED CURBS ARE AVAILABLE FOR PITCHED ROOFS.

SPECIFY PITCH:
EXAMPLE: 7/12 PITCH = 30° SLOPE.

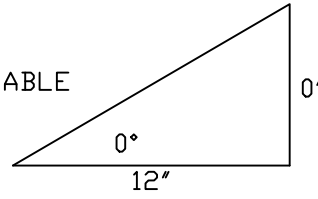

BACKDRAFT DAMPER INSTALLATION

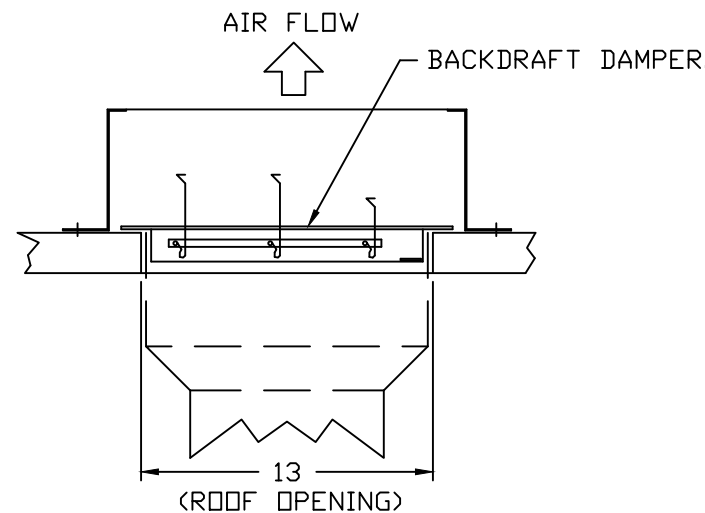

NOTE: UNLESS OTHERWISE STATED, PANDA RESTAURANT GROUP SHALL PROVIDE ALL EQUIPMENT ON THE FOLLOWING CAPTIVEAIRE SHEETS, INCLUDING: HOODS, FIRE SYTEM, EXHAUST FANS, SUPPLY FAN, BATHROOM FAN AND ELECTRICAL INTERLOCK PACKAGE

DOUBLE WALL DUCT BY MECHANICAL PLEASE USE CONTACT BELOW FOR PRICING

ANSUL GAS VALVE:

THE ANSUL GAS VALVE IS PROVIDED BY CAPTIVEAIRE SYSTEMS. CONTACT OUR OFFICE WITH THE VALVE SIZE 3 DAYS IN ADVANCE OF WHEN IT IS NEEDED ON SITE.

FOR QUESTIONS CALL THE CAPTIVEAIRE SOUTHERN CALIFORNIA OFFICE

3002 DDW AVENUE, SUITE 410
TUSTIN, CA 92780
TEL: 714-957-1500 EMAIL: REG66@CAPTIVEAIRE.COM

REVISIONS

DESCRIPTION	DATE:
Δ	
Δ	
Δ	
Δ	

www.captiveaire.com

Southern California Office

3002 Dow Ave., Suite 410, Tustin, CA 92780 PHONE: (714) 957-1500 FAX: (919) 227-5975 EMAIL: reg66@captiveaire.com

Panda Express - Bradenton FL (07969) - rev1
BRADENTON, FL, 34205

DATE: 1/11/2022

DWG.#:
5267198

DRAWN BY: AH-86

SCALE:
3/4" = 1'-0"

MASTER DRAWING

SHEET NO.
5



PANDA EXPRESS, INC.
1683 Walnut Grove Ave.
Rosemead, California
91770

Telephone: 626.799.9898
Facsimile: 626.372.8288

All ideas, designs, arrangement and plans indicated or represented by this drawing are the property of Panda Express Inc. and were created for use on this specific project. None of these ideas, designs, arrangements or plans may be used by or disclosed to any person, firm, or corporation without the written permission of Panda Express Inc.

REVISIONS:

Δ	COMMENTS/OWNER REV	02-02-22

ISSUE DATE:

1	CHECK SET	07-01-21
2	PERMIT SET	10-15-21
3	BID SET	02-22-22

DRAWN BY:

PANDA PROJECT #: S8-21-D7969
ARCH PROJECT #: P7359.2

www.cphcorp.com
A Full Service
A & E Firm

Plans Prepared By
Cph, Inc.

500 West Fulton St.
Sanford, FL 32771
Ph: 407.322.6841

Licenses:
Eng. C.O.A. No. 3215
Survey L.B. No. 7143
Arch. Lic. No. AA2600926
Lndscp. Lic. No. LC0000288

FOR INFORMATION ONLY

PANDA EXPRESS

TRUE WARM & WELCOME 2300
SR 70 & LORRAINE RD
BRADENTON, FL 34202

M-404

HOOD DETAIL PLAN

TRUE WARM & WELCOME 2300 R5