

CORNER RECORD

CR 11

COUNTY OF ALAMEDA T. 3 S R. 1 W M.D. MERIDIAN CALIFORNIA

CORNER TYPE: GOV'T. CORNER ☐ MEANDER ☐ RANCHO ☐ CONTROL ☐ OTHER ☐

CORNER IDENTIFICATION — DATE OF VISIT _____ 19____

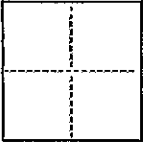

CORNER — LEFT AS FOUND ☐ FOUND AND TAGGED ☐ REESTABLISHED OBLITERATED CORNER ☐ REBUILT ☒

PHYSICAL DESCRIPTION OF CORNER FOUND; EVIDENCE AND METHOD USED TO IDENTIFY OR REESTABLISH
**TRANSIT AND TAPE USING BEARINGS AND DISTANCES
SHOWN ON MAP OF TRACT 1714.
MONUMENT DESTROYED BY CONSTRUCTION.**

PHYSICAL DESCRIPTION OF MONUMENTS REBUILT OR PERPETUATED
STANDARD CITY OF HAYWARD MONUMENT DISC.

CALIFORNIA COORDINATE SYSTEM ORDER: FIRST ☐ SECOND ☐ THIRD ☒
STATIONS USED: NGS (USC & GS) ☐ STATE ☐ COUNTY ☐ OTHER ☒ STATION _____
ZONE _____ ELEVATION _____ NORTHINGS (Y) _____ EASTINGS (X) _____

(Fold)

SKETCH: (Include reference tie or witness points, remarks and topo of area)

TR. 1714

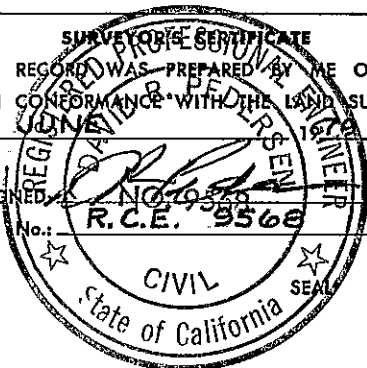
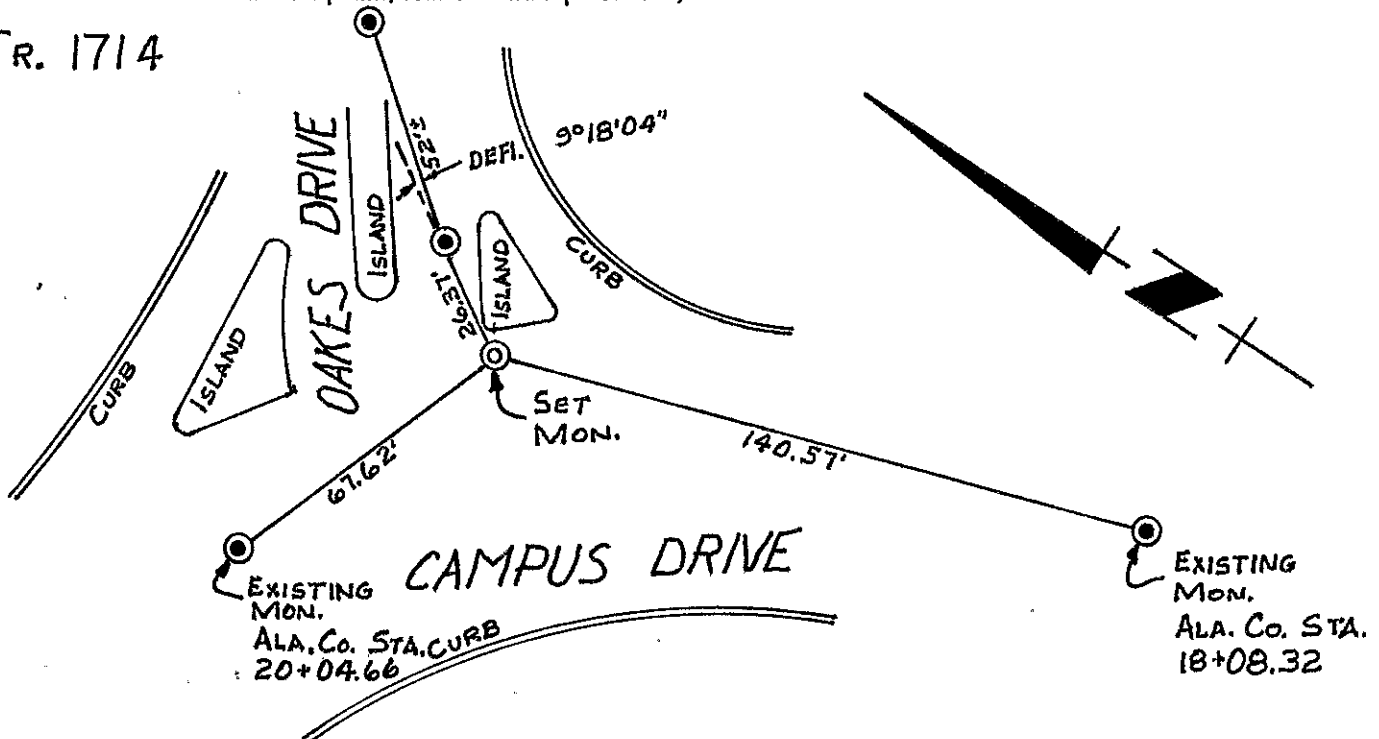

COUNTY SURVEYOR'S CERTIFICATE

THE CORNER RECORD WAS RECEIVED July 14 1979
AND EXAMINED AND FILED August 7 1979
BY: Edgar H. Meyer
TITLE: Deputy County Surveyor

DOCUMENT No. 79-1

STATEMENT ON BACK OF SHEET

BK 1 C.R. pg 11

YES ☐ NO ☒