

# TRACT NO. 36-49 LA VISTA BLANC

MONO COUNTY, CALIFORNIA

SEPTEMBER, 1972

WILLIAMSON & SCHMID, CIVIL ENGINEERS

GERALD F. OLDENBURG, L.S. 3246

FOR CONDOMINIUM PURPOSES

1 LOT AND 80 CONDOMINIUM UNITS  
3.942 ACRES

## NOTE:

1. THESE PLANS SHOWN ON SHEETS 9, 10 AND 11, REPRESENT TYPICAL BUILDINGS TO BE ERECTED TO CONTAIN UNITS 1 TO 80, INCLUSIVE.
2. SEE SHEET N° 11 FOR TYPICAL SECTIONS AND VERTICAL LIMITS OF UNITS
3. ALL LINES SHOWN HEREON INTERSECT AT RIGHT ANGLES.
4. ALL WALLS ARE 0.34' THICK UNLESS OTHERWISE NOTED.

SEE SHEET 11 FOR GENERAL NOTES.

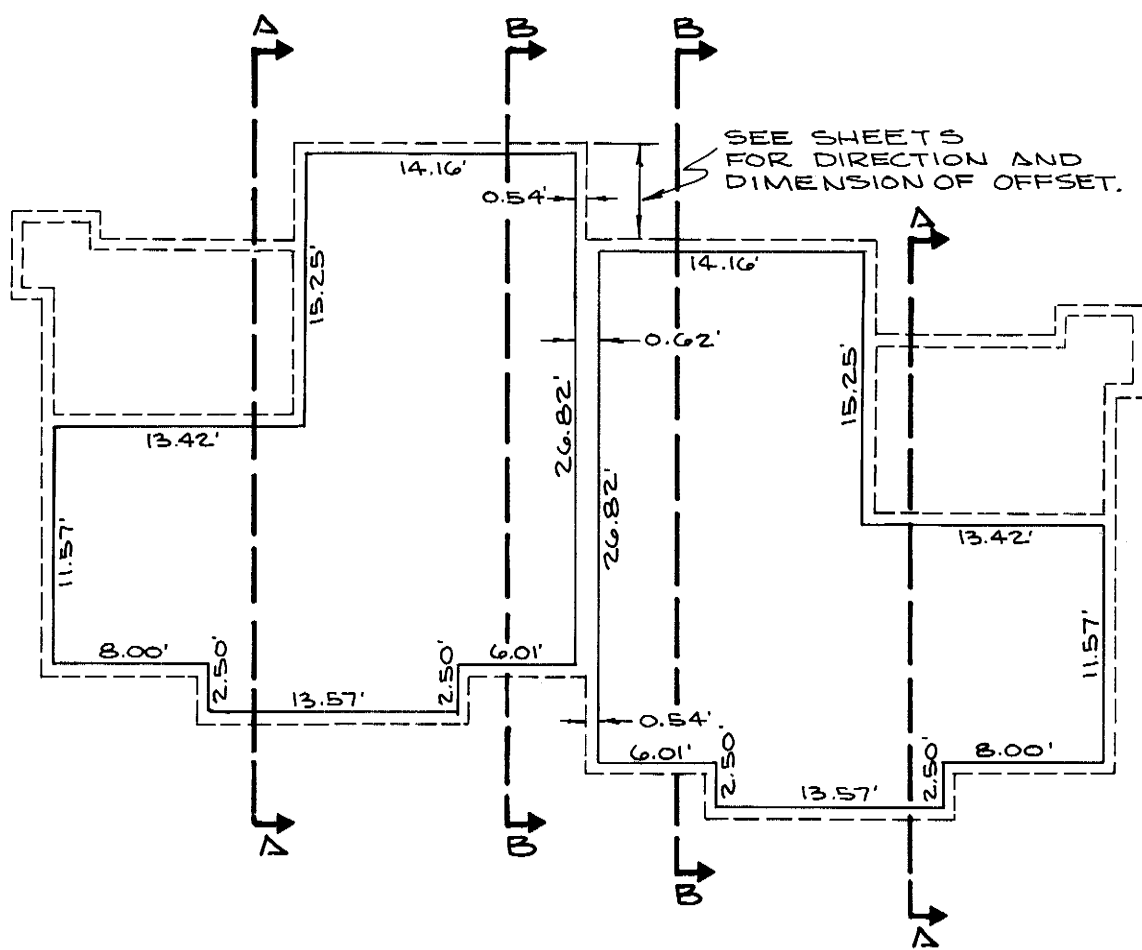

THIRD FLOOR

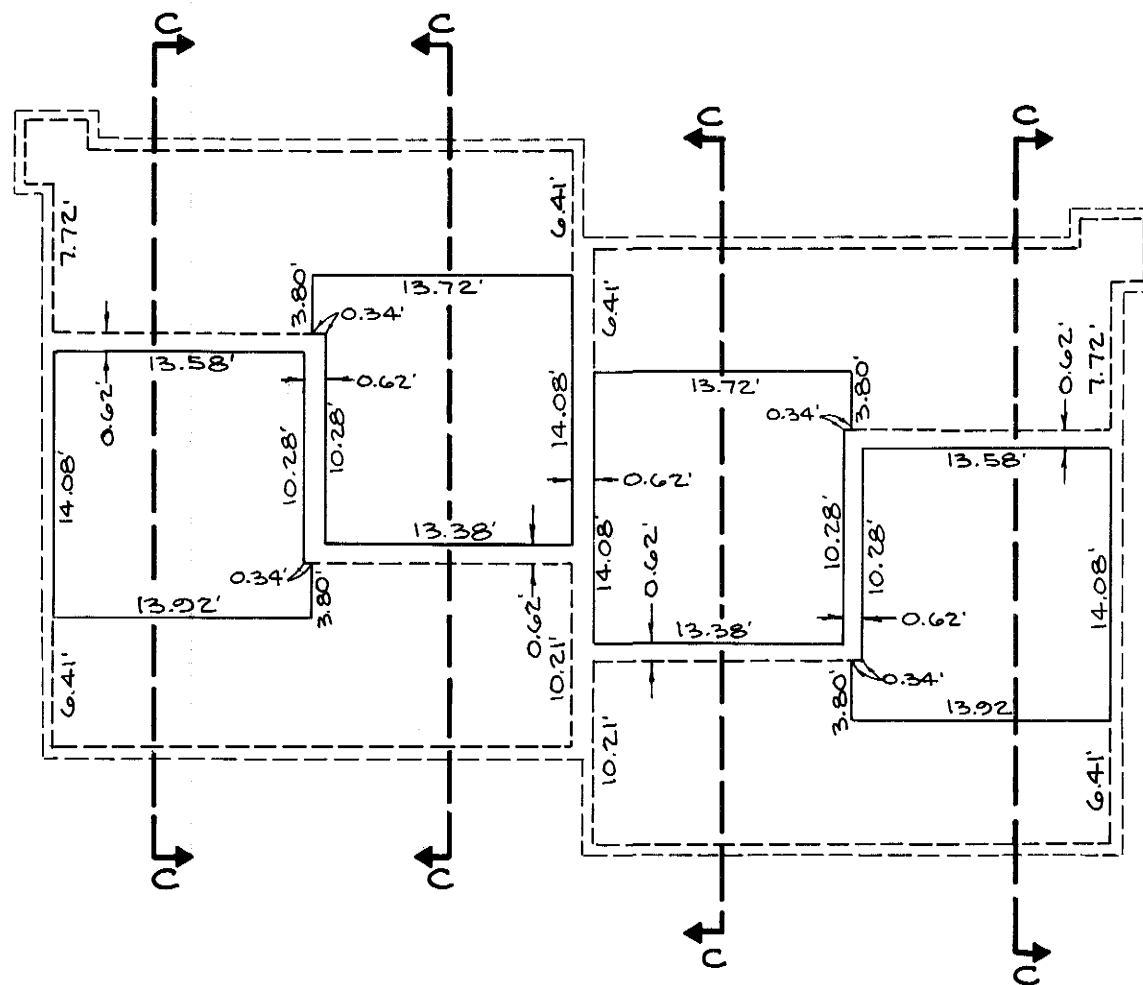

MEZZANINE

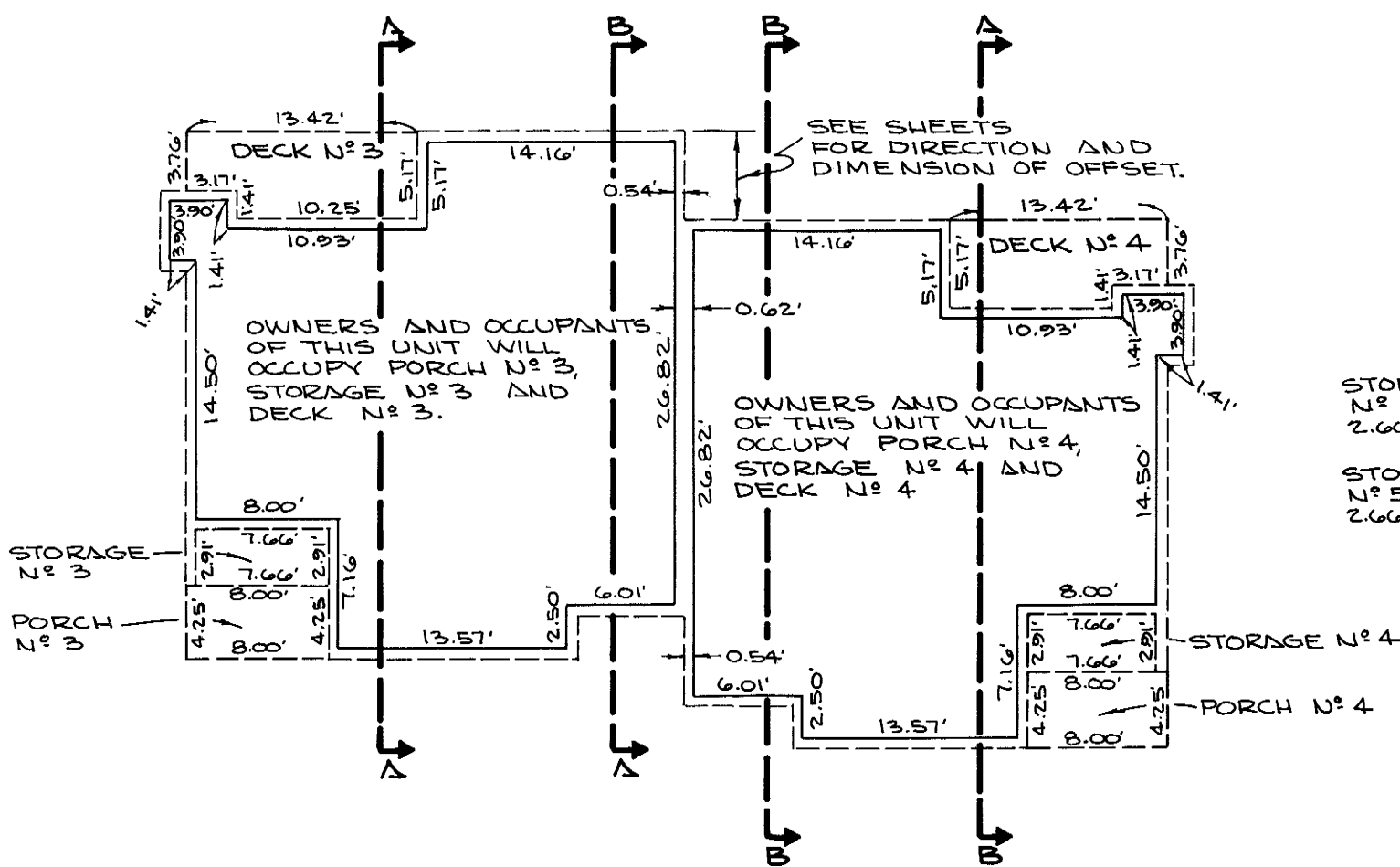

SECOND FLOOR

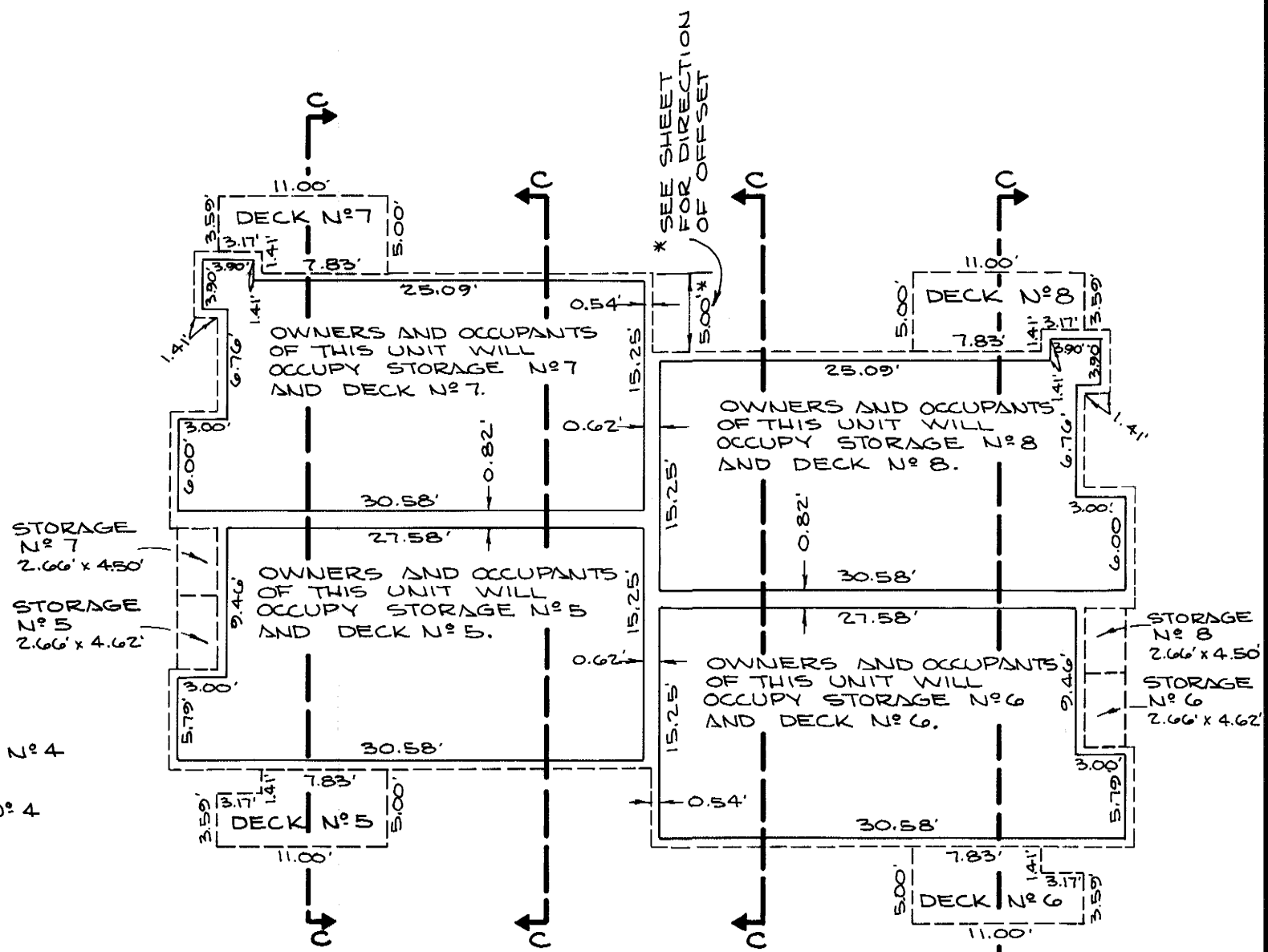

SECOND FLOOR

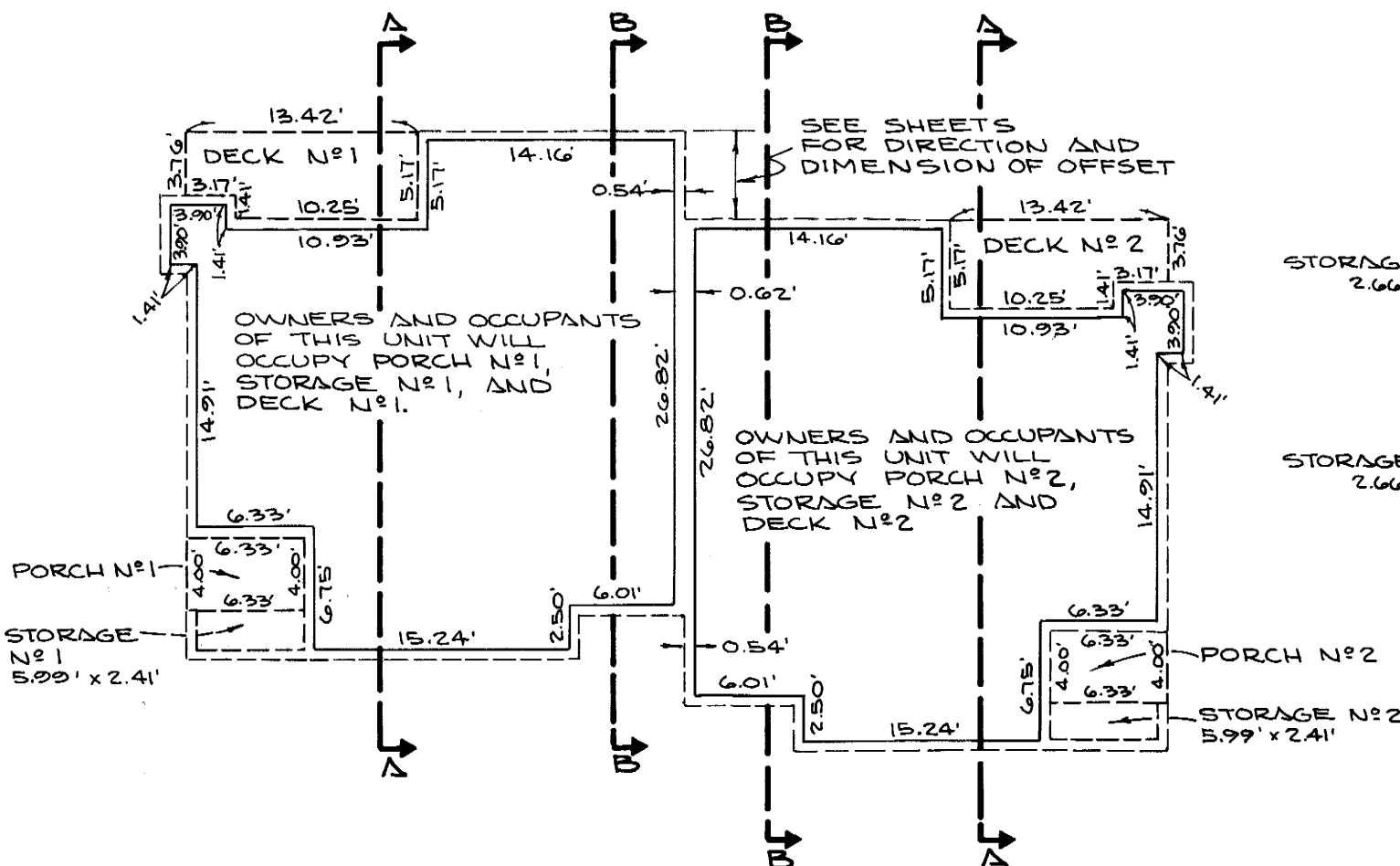

FIRST FLOOR  
CASE I

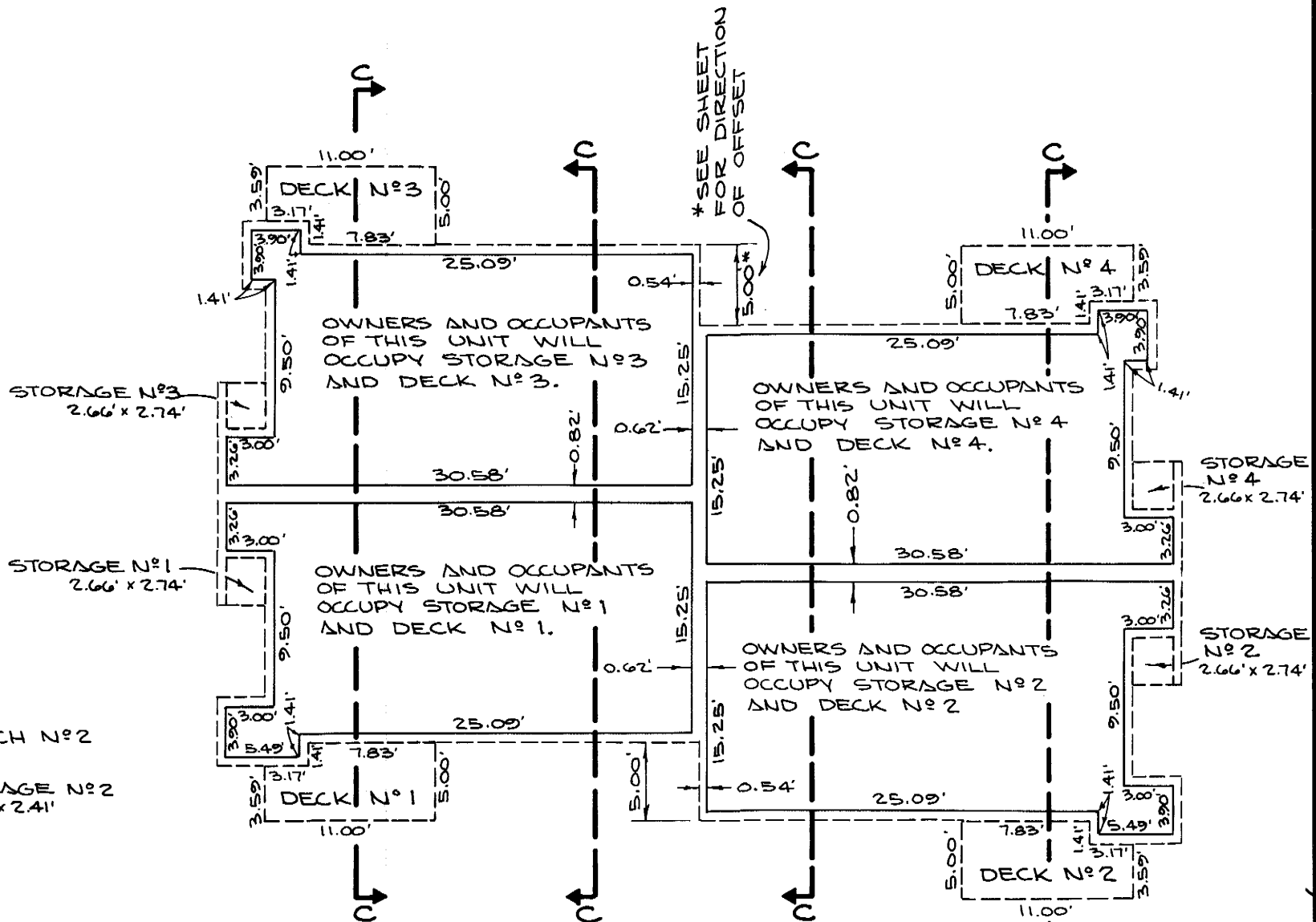

FIRST FLOOR  
CASE II

Vol. 8, Pg. 25-H