

CITY OF ANAHEIM ELECTRICAL NOTE

THERE ARE EXISTING 69KV, 12KV AND STREETLIGHT OVERHEAD AND UNDERGROUND ELECTRICAL FACILITIES WITHIN THE PROJECT'S BOUNDARY. PLEASE PROTECT ALL ABOVEGROUND AND UNDERGROUND ELECTRICAL FACILITIES IN PLACE AND CONTACT UTILITY INSPECTOR JEFF ROBISON AT 714-292-8881 PRIOR TO WORKING WITHIN PROXIMITY TO ENERGIZE ELECTRICAL FACILITIES.

ANY ADJUSTMENTS OF ELECTRICAL PULLBOXES AND VAULTS TO FINAL GRADE, PLEASE COORDINATE WITH UTILITY INSPECTOR AT LEAST 48 HOURS PRIOR TO THE PLANNED WORK. MAINTAIN ALL CLEARANCES PER GENERAL ORDER 95 AND 128. ANY PROPOSED ELECTRICAL PULLBOXES/VAULTS/POLES REQUIRING RELOCATION REQUIRED, PLEASE CONTACT VINH TRAN AT 714-765-4273.

| PROFILE SCALE |        |
|---------------|--------|
| HORIZ.        | 1"=20' |
| VERT.         | 1"= 2' |

CONSTRUCTION NOTES

- EXCAVATE FOR PROPOSED STRUCTURAL SECTION AND IMPROVEMENTS.
- CONSTRUCT 7" AC, INCLUDED 2" THICK ARHM SURFACE COURSE OVER 14" CLASS II AB.
- COLD MILL 4" THICK EXISTING AC PAVEMENT.
- CONSTRUCT 4" AC, INCLUDES 2" THICK ARHM SURFACE COURSE.
- COLD MILL 2" THICK EXISTING AC PAVEMENT.
- CONSTRUCT 2" THICK ARHM OVERLAY.
- ADJUST EXIST. SEWER/STORM DRAIN MANHOLE TO GRADE PER CITY OF FULLERTON
- REMOVE AND REPLACE EXIST. PULL BOX OUTSIDE CURB RETURN PER CITY OF ANAHEIM STANDARDS.
- REMOVE EXIST. CURB AND GUTTER AND SIDEWALK AND RECONSTRUCT PCC CURB RAMP PER APWA STD PLAN 111-3 WITH DETECTABLE WARNING SURFACE (3'x4' TRUNCATED DOMES, DARK GREY IN COLOR) CASE B, TYPE 1.
- ADJUST EXIST. WATER VALVE TO GRADE.
- REMOVE EXIST. ABANDONED TRAFFIC SIGNAL PULL BOX PER CITY OF ANAHEIM STANDARDS.
- CONSTRUCT 6" THICK AC BASE.
- ADJUST EXIST. MANHOLE TO GRADE PER CITY OF PLACENTIA STANDARDS.
- ADJUST EXIST. WATER VALVE TO GRADE PER GOLDEN STATE WATER COMPANY STANDARDS.

DISPOSITION NOTE

- PROTECT IN PLACE

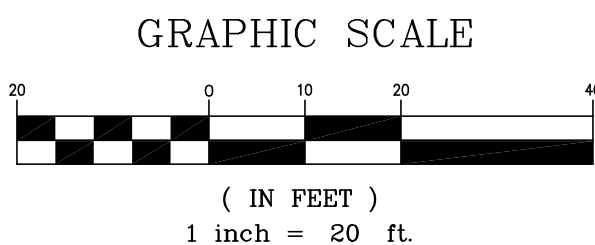
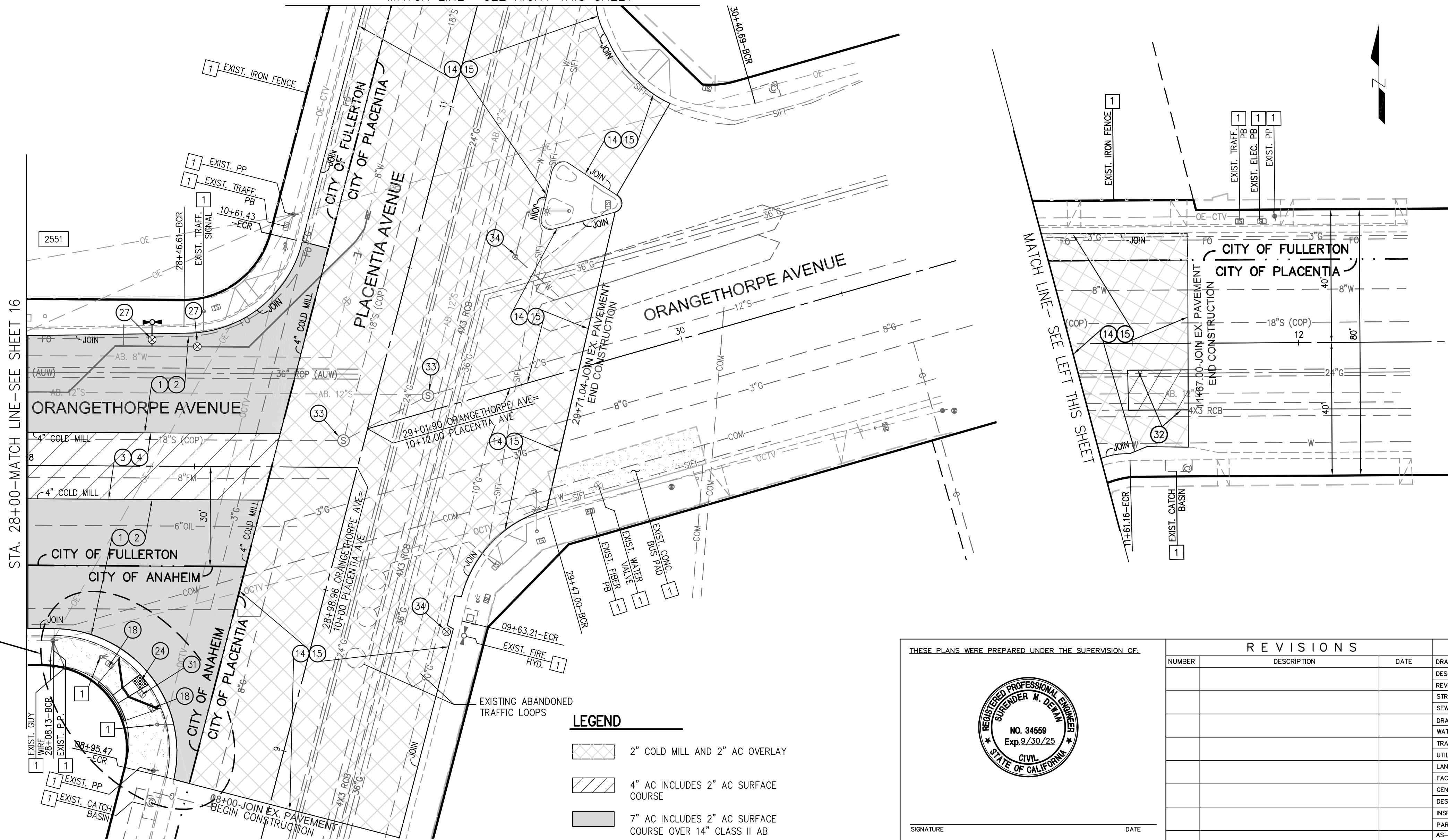

THESE PLANS WERE PREPARED UNDER THE SUPERVISION OF:



SIGNATURE DATE

REVISIONS

| NUMBER | DESCRIPTION  | DATE | DRAWN | INITIALS | DATE  |
|--------|--------------|------|-------|----------|-------|
|        | DESIGNED     |      | NC    |          | 04/24 |
|        | REVIEWED     |      | SD    |          | 04/24 |
|        | STREET       |      |       |          |       |
|        | SEWER        |      |       |          |       |
|        | DRAINAGE     |      |       |          |       |
|        | WATER        |      |       |          |       |
|        | TRAFFIC      |      |       |          |       |
|        | UTILITY/ELEC |      |       |          |       |
|        | LANDSCAPE    |      |       |          |       |
|        | FACILITIES   |      |       |          |       |
|        | GENERAL ENG  |      |       |          |       |
|        | DESIGN ENG   |      |       |          |       |
|        | INSPECTION   |      |       |          |       |
|        | PARKS & REC  |      |       |          |       |
|        | AS-BUILT     |      |       |          |       |

CITY OF FULLERTON  
PUBLIC WORKS DEPARTMENT

ORANGETHORPE AVENUE RECONSTRUCTION PROJECT  
CIP PROJECT

STREET IMPROVEMENTS-PLACENTIA AVE  
FROM STA. 25+00 TO STA. 30+70.00

APPROVED:

ACCEPTED:

DATE CITY ENGINEER/ASSISTANT PUBLIC WORKS DIRECTOR

DATE PUBLIC WORKS DIRECTOR

SCALE: 1" = 20'

SHEET 17 OF 21 SHEETS

CITY OF FULLERTON BM NO.: 35-37 ELEV = 173.90'  
B.M.: P.K. NAIL IN LEAD, N.E. COR. RAYMOND AND WILSHIRE, E.  
CURB OF RAYMOND, 1" N. OF E.C.B.

FILE: 7082